

STEPS FOR ASSEMBLING INTERLINK 6

① Connect RL3 legs together by two pegs



③ Remove both arms.



NOTE:
Removed parts may be used at different stages of assembly.

②

Swing cover from side of foot to front and peg into hole



④

Remove jet packs from back



⑥

Remove LL4's rear guard and unplug the hoses



⑦

Remove ankle shields, knee shield and connector for each leg



⑤

Place either jet pack (they are interchangeable) into RL3's left shoulder hole



⑧

The inner ankle shields are to be pegged to the opposite hip hole. Lift torso armor to enable you to connect the shields together

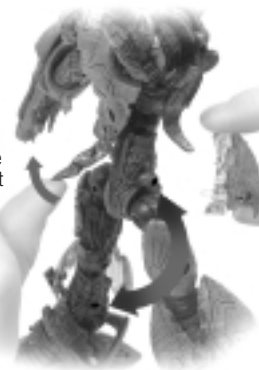

⑨

The shields connect together under the armor. The shields also peg together in the back



⑩

Move outer ankle shields up to thighs, then plug rear guard tabs and pegs into shield slots and holes



STEPS FOR ASSEMBLING INTERLINK 6 - CONTINUED

- 11 Rear guard hoses peg into back of feet



- 12

Remove hand, slide arm gun off, then reattach hand.



- 13

Fold arms behind back



- 14 Place other jet pack into top right shoulder hole of LL4

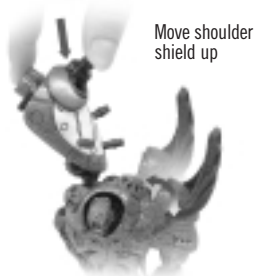

Move shoulder shield up

- 15

Flip down TS2's chest block and snap square plug in hole



- 16

Remove head from front of body and pin onto chest block near hinge



- 17

Remove pod/antenna assembly of HD1 as well as right forearm cover



- 17

Extend torso by pulling up



CONNECTING
HD1 TO TS2

- 18

Legs of HD1 should be rotated up (90° from torso), exposing a hole in the upper ball joint. That hole pins onto the empty head post of TS2



STEPS FOR ASSEMBLING INTERLINK 6 - CONTINUED

19

There are two T-pins on **TS2** that slide into the lower ball joint of **HD1**. Slide the longer side of the T-pin bar into one of the side holes as far as you can, allowing room to rotate the other T-pin bar to line up with the other hole.



Then move **HD1** to be center in the middle of T-pins. You may have to repin **HD1** back onto head post of **TS2**

20

HD1's foot plates have a loop at the end that attaches to hooks at the back feet of **TS2**



21

Arms from **RL3** plug into holes of **TS2** located at the side of its torso



22

The key lock tab from **RL3**'s jet pack pins into holes in **TS2**'s chest block.

23

After inserting tab, turn leg to lock in tab

CONNECTING
LL4 ► TO ◀ TS2



24

Repeat same procedure as in step 22 and step 23

25

Remove inner leg covers on **RA5** and peg into chest plate



STEPS FOR ASSEMBLING INTERLINK 6 - CONTINUED

26

Press feet together and insert peg into hole

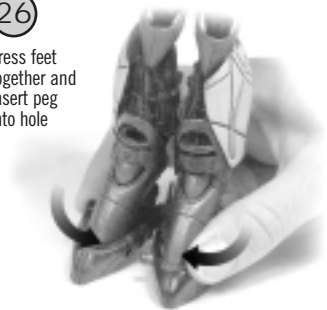

27

Remove right arm and head



28

Peg right arm into head hole



CONNECTING
RA5 ▶ TO ◀ TS2

30

The key lock hole in RA5's back fits onto key lock tab from TS2's shoulder



29

Turn lower torso and legs around 180°



31

Once connected rotate RA5 forward to lock on arm onto TS2

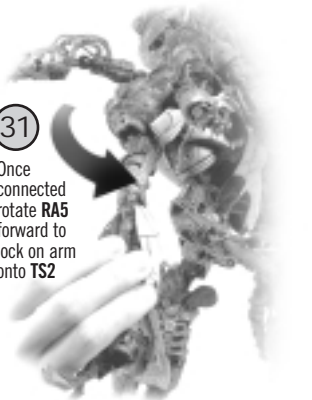

34

Detach lower leg shield and left forearm covering

33

Detach all pieces from shoulder canopy

32

Remove shoulder canopy of LAG

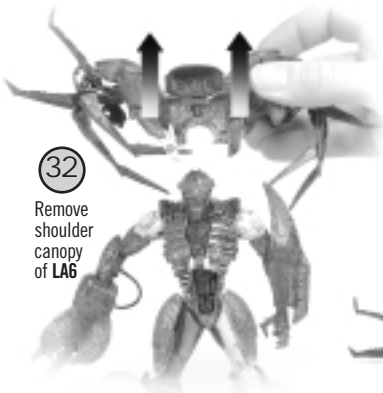

STEPS FOR ASSEMBLING INTERLINK 6 - CONTINUED

35

Turn out legs at upper thigh to have heels and calves back to back. Then pivot feet to point up

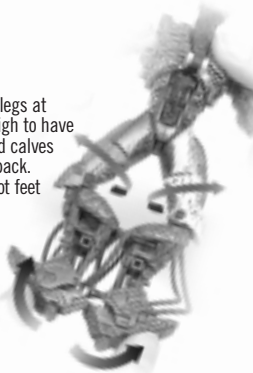

36

Take one lower leg shield and peg into holes on front side. Repeat on backside with other shield



37

Peg the shield that was on the forearm to the back



38

Connect the two pieces taken off the shoulder canopy together

39

Then connect those two pieces to the shoulder canopy as shown



40

Continue by pegging that canopy assembly into two holes in LA6's back

41

Shoulder claws peg into holes on soles of shoes



42

Flip down head to expose key lock hole for attaching to TS2

CONNECTING
LA6 TO TS2

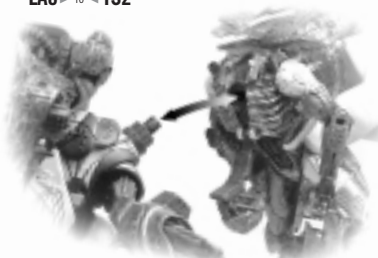

43

Line up slot from LA6 to peg of TS2 and push together. Then rotate arm forward to lock on peg

STEPS FOR ASSEMBLING FUELING STATION FOR INTERLINK 6

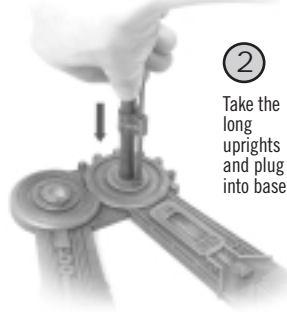
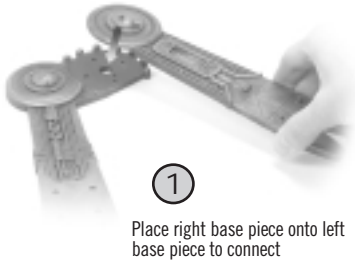

**CONNECTING
INTERLINK 6 TO BASE**

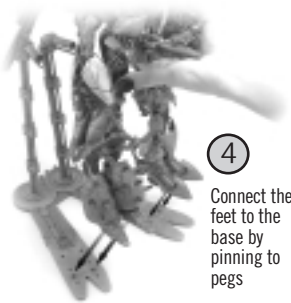

LOCATION OF REMAINING PARTS

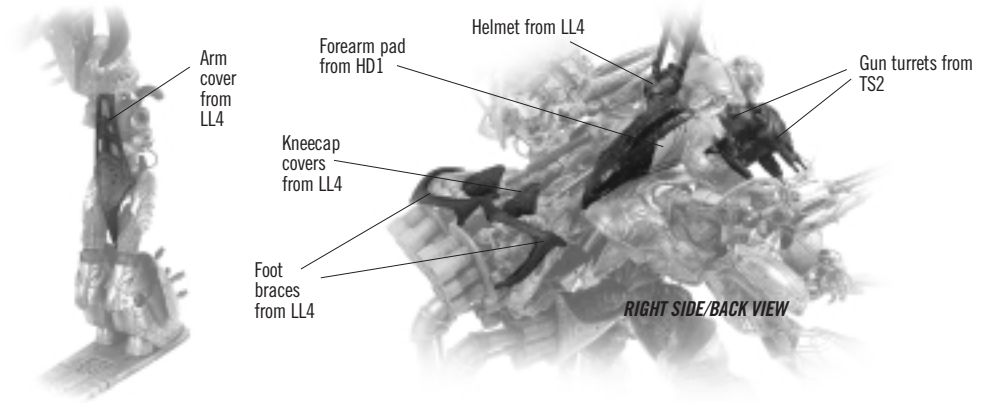
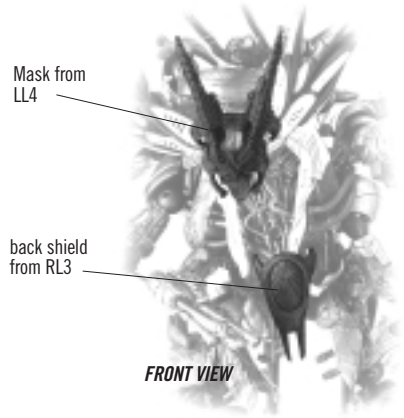
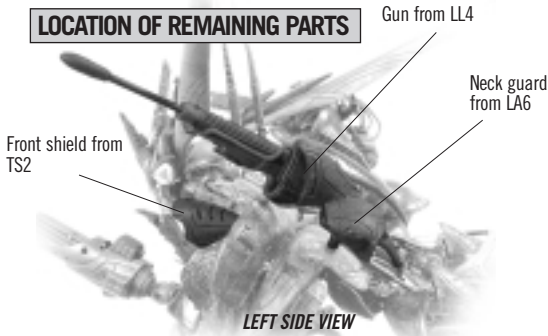

**INDIVIDUAL ROBOT
ASSEMBLY for HD1**

After removing robot from packaging you will need to attach each 8" antennas to a shoulder pods as shown. Antennas are interchangeable and cannot be removed after they are attached to pod.



Proceed to peg pod/antenna assemble to shoulder guard cover. Larger two pegs attach to HD1's left side and smaller pegs go to right side.

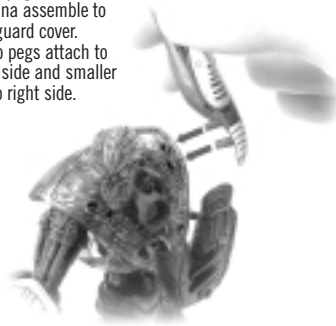

**INDIVIDUAL ROBOT
ASSEMBLY for TS2**

The two gun turrets plug onto shoulders as shown.



Right arm gatling gun has wind-up action. Turn clockwise to wind and press release tab to spin

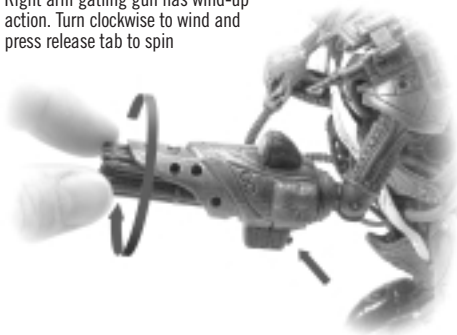

**INDIVIDUAL ROBOT
ASSEMBLY for RL3**

Jet packs plug into either hole in back.



Load missile into hole on right forearm pad. Pull back and release to fire

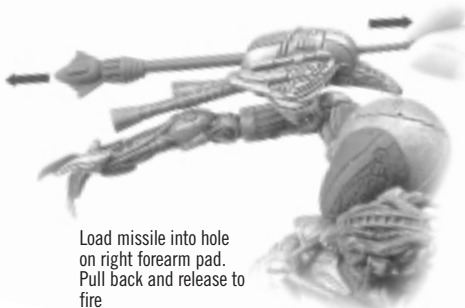

INDIVIDUAL ROBOT
ASSEMBLY for **LL4**

Load missile into hole on right forearm pad.
Pull back and release to fire



Helmet snaps into collar



Mask clips onto back hooks



Shoulder shields plug into holes above arms

INDIVIDUAL ROBOT
ASSEMBLY for **RA5**

Pivot trigger up and down to move chainsaw blades

Mask clips over head

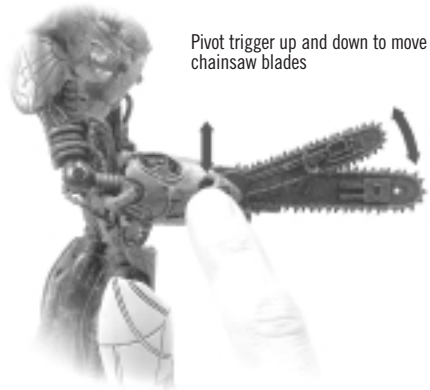

INDIVIDUAL ROBOT
ASSEMBLY for **LA6**



Shoulder claws have multiple pivot points